

Not shown: inner tube and axle bolt
Modify as needed for TR87 style 90° valve stem

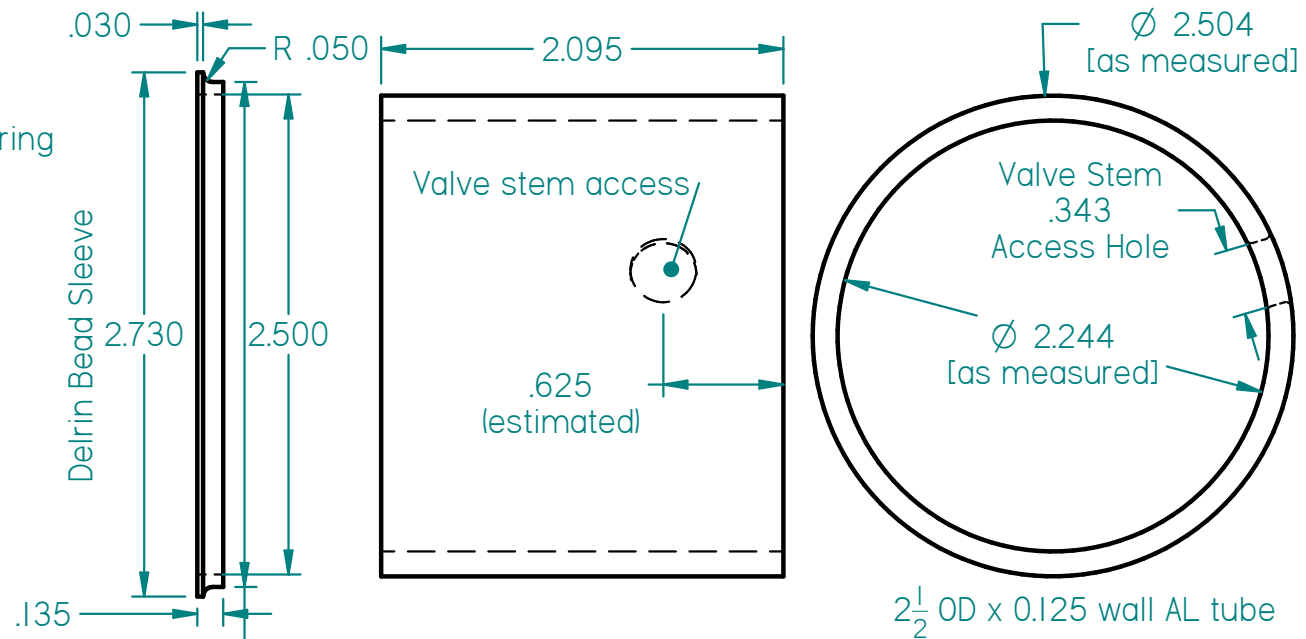

Rim Flange valve stem side

Rim Flange threaded side [mirror image] but drill and tap to match tire band phasing

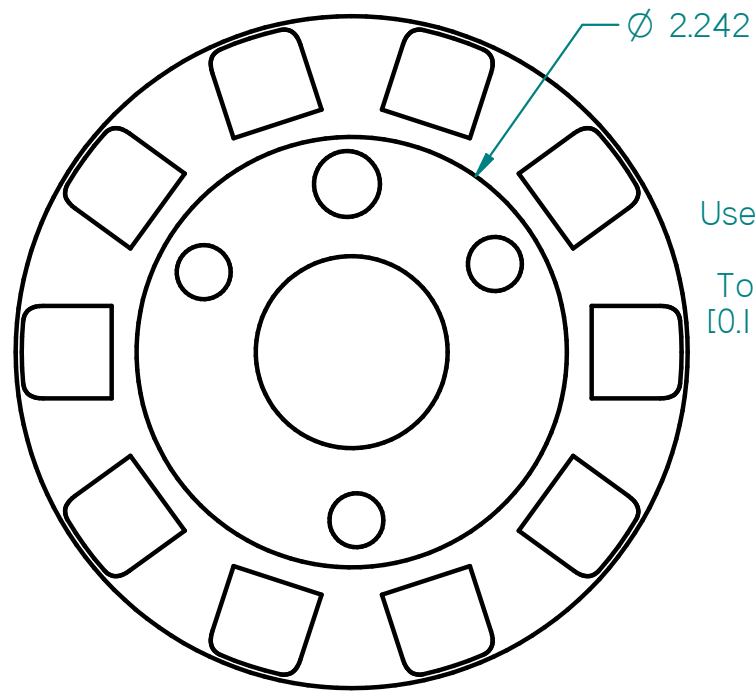
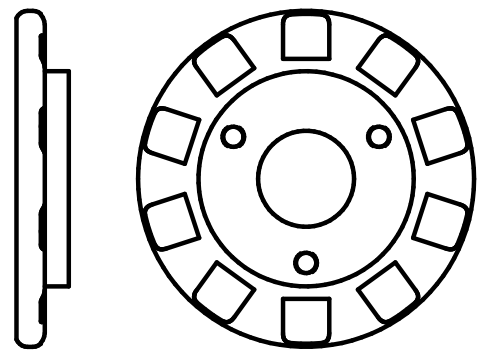

Use 3/16 End Mill .326 Total Traverse [0.163 from C/L]

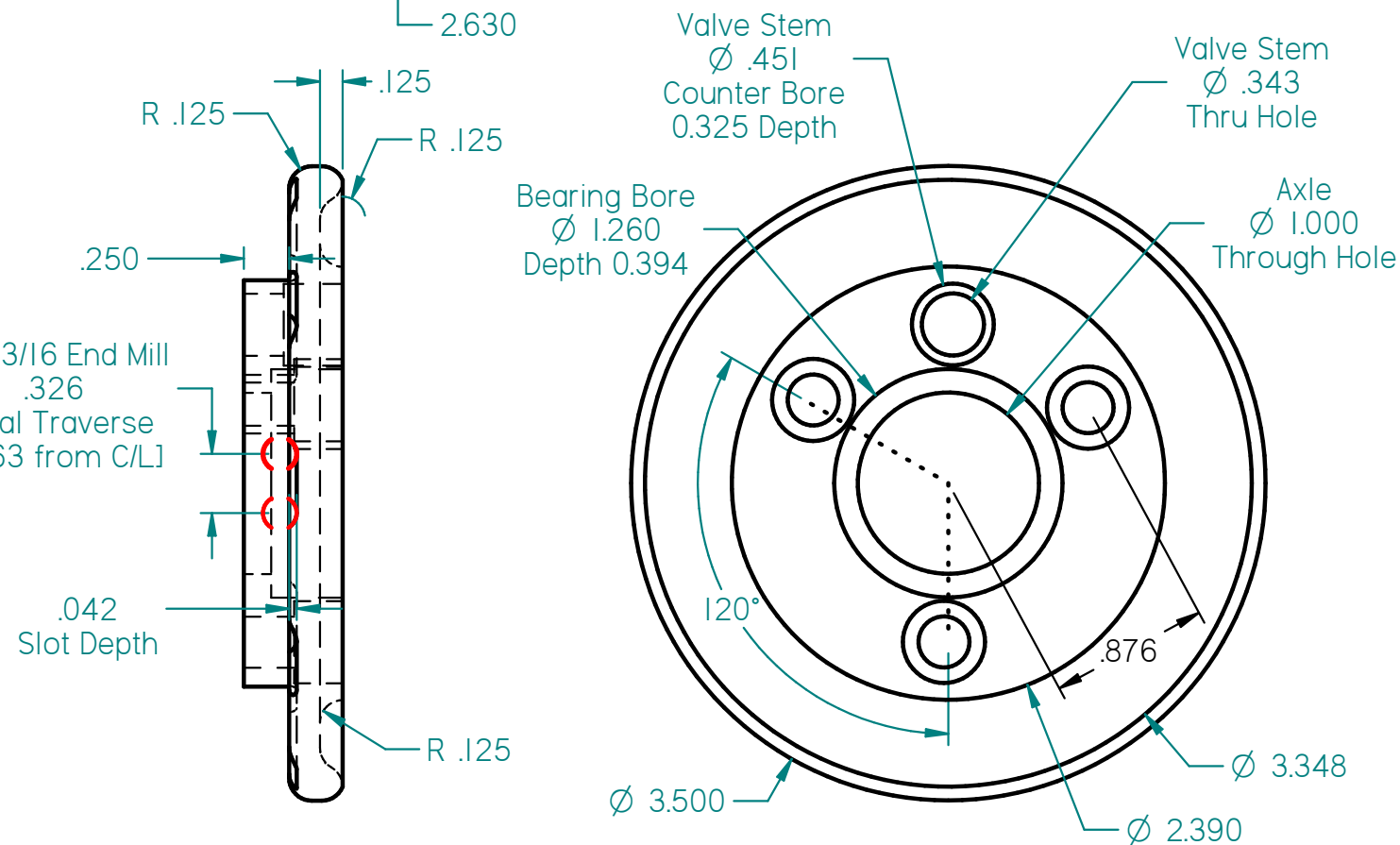

Center spacer - make long and fine tune during assembly

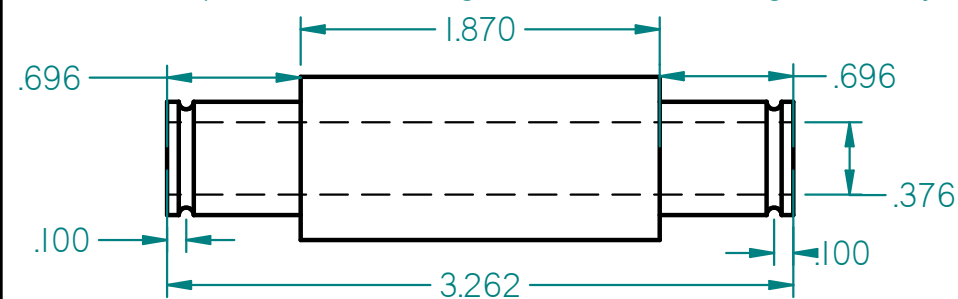

Outside Axle Spacer

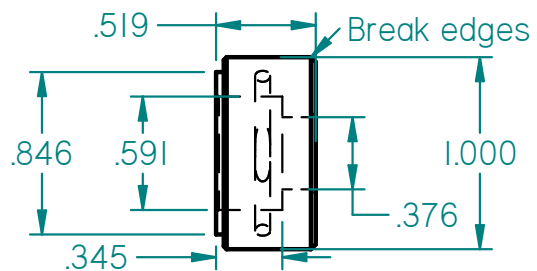

Material: 6061 T6

| | NAME | DATE | KITPLANES | |
|---|---------|----------|----------------------------|----------------------------------|
| DRAWN | bhadley | 04/18/18 | TITLE | |
| CHECKED | | | Wheel for 200 x 80 AC tire | |
| ENG APPR | | | SIZE | DWG NO |
| MGR APPR | | | B | 4-18-2018BHD1 |
| UNLESS OTHERWISE SPECIFIED DIMENSIONS ARE IN INCHES ANGLES ±0.5° ±0.002 unless noted | | | FILE NAME: | wheel assembly 200 x 80 tire.dft |
| | | | SCALE: | WEIGHT: |
| | | | SHEET 1 OF 1 | |